

## 2013 Dodge or Ram Truck Grand Caravan V6-3.6L

Vehicle > Engine, Cooling and Exhaust > Exhaust System > Description and Operation > Components

### GAS

The exhaust system consists of two catalytic converters, muffler (2) and a resonator assembly (1). The system is serviced in five sections; the front and rear catalytic converters, the cross-under pipe, the flex pipe, and the muffler and resonator with connecting pipe.

A band clamp (3) is used to connect the joint between the two components. Three support hanger rods with rubber isolators (4) are used to support and isolate the exhaust system. A flexible joint, integral to the down pipe. Is bolted from the cross-under pipe. It allows engine movement.

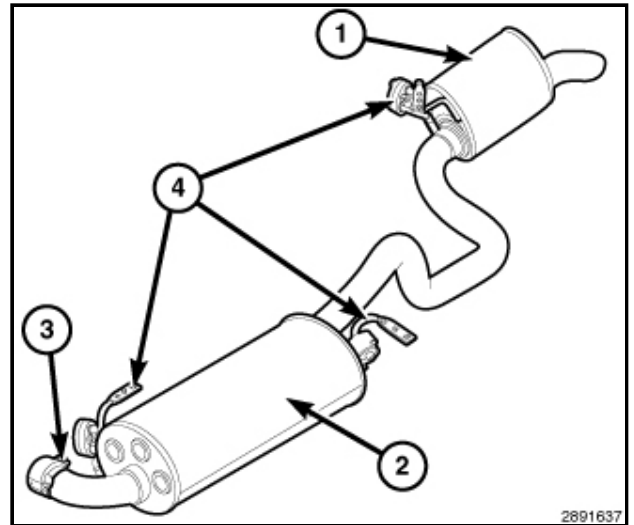

The 3.6L connects the two catalytic converters by the use of a cross-under pipe. The 3.6L catalytic converters (3) are bolted to the integrated exhaust manifold (1). A steel retainer bracket (4) is used to hold the lower section of the flange while two bolts (2) are used to secure the flange to the integrated exhaust manifold. The exhaust manifolds are part of the cylinder head. They are non removable. If any damage is found to the manifolds. The cylinder head must be repaired or replaced.

